

# TC-9500N

## Continuous Ink Jet Printing System

*Efficient systems.....Economical Codes*



- Colour Touchscreen ● True Type Fonts ● 5 Lines of print ● Long service interval
- Lifetime Pump Warranty ● 24 Months Standard On-Site Warranty

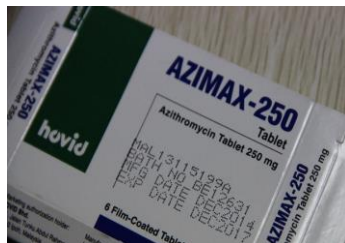

# TC-9500N Data Sheet

## Dimensions

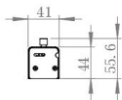
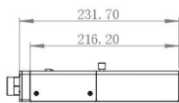
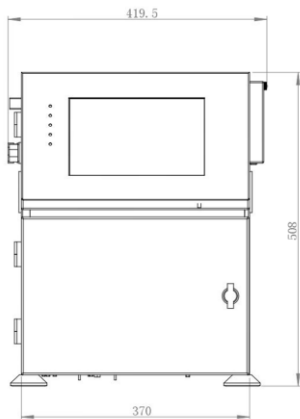
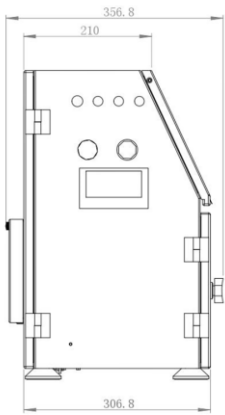

## Hardware features

- 10.1-inch full colour touch screen with tough, solvent-resistant polymer cover
- Service Module, change interval: 6000Hours – dye-based inks, up to 12 months (4,000 hours) – soft pigmented inks\*
- Unique automatic printhead flushing:
- Printhead jet-speed control and temperature sensing for consistent printing in changing ambient temperatures
- Mistake-proof, mess-free ink and solvent refilling while printing (0.750 litre ink cartridge, 0.750 litre solvent cartridge)
- Durable ink pump with no scheduled changes required, Lifetime (12 Years) warranty
- Extended shutdowns (up to 3 months) without printer flushing or draining.
- Robust, flexible tube conduit for static and moving printhead applications

## Software features

- Single-press start print, pause print and jet shutdown
- Simple message creation and editing with drag-and-drop field positioning and zoom function for long messages
- Total print count, message count and batch count
- Message store display and message style selection
- Password-protected functions, with customisable user profiles
- Message creation/editing while printing
- On-screen output rate measurement and production stoppage log. Downloadable onto USB
- On-screen fluid level indicators, 12 hour running from fluid refill warning to printer stop in most applications
- Multiple operator languages (user selectable) with on-screen keyboards, secondary keyboard for multi-language printing
- Simple line speed and shaft encoder setup wizard, for installation on new production lines
- Simple Communications Protocol (BCD based scripts) and TruCode Remote Communications Interface for connection to PCs or PLCs using Ethernet port or optional RS232 port

## Message printing facilities

- Text, symbols, Bar codes and numbers prompted fields for one-step message editing with customisable on-screen prompts
- Height, width and delay functions for easy code sizing and positioning
- Automatic formats for printing dates and times (using the printer's internal clock)
- Custom date and time editor to create different date formats as required
- Automatic date forward function. Add number of seconds, minutes, hours to the current time, or number of days, weeks or months to the current date
- Automatic time adjustment option for daylight savings time
- Sequential numbering, forward and backward counting, variable intervals, multiple number ranges, alphanumeric sequencing
- One touch sequential number reset option from the printer screen,
- Sequential text fields, increment and reset sequences using external triggers, optional one touch sequence reset from the printer screen
- Number of messages stored: up to 1000 using internal printer memory (depending on message content), more can be stored using a USB storage device
- Bold character printing (up to 9 times)
- Shift coding (message content changes automatically at defined times)

## Ink range

- TruCode® MEK base (dye-based, soft pigmented-based)
- TruCode® mixed base (MEK-free, dye based)
- TruCode® ethanol base (MEK-free, dye based)

## Physical characteristics

- Base and enclosure: Stainless steel IP55 environmental protection rating\*\*
- Mounting options: Static stand, mobile stand, bench, shelf for wall mounting
- Operating temperature range: 5-45°C for MEK base, Mixed base, Ethanol base ink types
- Humidity range (r.h., non-condensing): 90% max
- Power supply: 100-230V, 50/60Hz
- Power consumption: 38W (typical when printing)
- Power rating: 150 W
- Weight: 24.5kg (including fluids and printhead)

## Connections/interfacing for

- Product detector
- Shaft encoder/second product detector
- External single-stage alarm output (24v) with multi-stage alarm option
- USB
- Ethernet
- Volt-free contact alarm connection (e.g. for use with external mains-driven alarm) (option)
- Dual alarm output (Volt-free and 24V output) (option)
- RS232 (option) and Parallel I/O (option)

## Robust Printhead

We at TruCode® are glad to present Our customers with a printhead Customised for Indian climate. The Printhead is easily accessible for any service if required and does not come with any expensive components. Our R&D team has developed a head Which truly suits almost all the Purpose applications and does not require frequent cleaning. The printhead does not require any external air supply to work and has a state of art nozzle which does not gets blocked. Thus providing quality prints with maximum uptime.



## Consumables

TruCode® consumables are customised for fast and efficient coding onto variety of substrates available today. The state of art consumables provides mess-free



Refills without exposing the The ink or solvent to external Environment thus avoiding Evaporation and reduce the consumption .

TruCode® consumables come in 0.750Litre spill proof cartridges protected by RFID thus also avoiding inserting the wrong consumables which

eventually increases the uptime of the printer and proved complete peace of mind.

For More Information .:



www.trucode.in



## TruCode Technologies Pvt Ltd

#A-103, "SINCHAN" CHS, off. Veera Desai Road, Opp. Chitrakut Party

Plot, Andheri(W), MUMBAI. 400 053. INDIA.

Ph: +91 98213 17635, +91 89755 29595

Email: sales@trucode.in